

I About Tsuyama

■About Tsuyama

Tsuyama city is located in the north eastern part of Okayama Prefecture. Historically, the city developed and flourished as a castle town with Tsuyama Castle as its centre (which is now part of Kakuzan Park). Today the city plays a leading role in the northern part of the Prefecture making significant contributions to administration, economics, education and medical care.



As it is surrounded by mountains, the difference in temperature between daytime and nighttime is quite significant. The average temperature throughout a year is between 13 ~ 14°C and it is about 11~12°C in the northern part of the city. In summer, one will experience a heat wave with the temperature rising above 30°C. In winter, the temperature drops and the area is often covered in snow.

■Sightseeing Spots

Tsuyama Castle (Kakuzan Park), Shurakuen Garden, Joto Street, Tsuyama Museum of Science Education, Yokono Falls, Lake Park Kamo, Okutsu River Ravine Town, Aba Hot Springs Resort, Nuno Falls, etc.



■Annual Traditional Events

April	Tsuyama Cherry Blossom Festival	Tsuyama Castle	from 1st to 15th
	Nakayama Shrine Rice Planting Festival	Nakayama Shrine	on 29th
May	Seigenji Temple Peony Festival	Seigenji Temple	Late April to early May
	Aba Children' s Fishing Competition	Aba Forest Park	5th
June	Tsuyama Azalea Blossom Festival	Green Hills, Tsuyama Region Center	Late May to early June
	Chouhouji Temple Hydrangea Festival	Chouhouji Temple	Mid June
August	Gongo Festival	riverbanks of the Yoshii River	First Saturday and Sunday
	Shiode Pond Fireworks Festival	Shiode Pond	12th
October	Tsuyama Josai Museum Fair	Josai area	First Sunday
	Tsuyama Autumn Festival	in the city centre	Third and Fourth Saturday
	Monomi Shrine Flower Festival	Kamo neighborhood	Fourth Sunday
November	Niino Festival	Niino yamagata, Shohoku area	3rd
	Aba Hachiman Shrine Flower Festival	Aba elementary school ground	3rd
	Old Joto Street Festival	Joto Street	First Sunday
December	Kifune Shrine Wolf Worshipping Festival	Kume area	from 13th to 15th
January	Fukuriki-Kojin Festival	Fukuriki-Kojin Shrine	1st - 3rd of the lunar New year
February	Manpukuji Buddhist Memorial Service (for celebrating children' s 13th birthday)	Manpukuji Temple	Last Friday, Saturday and Sunday

■The Map of the City Hall and its Surrounding Area

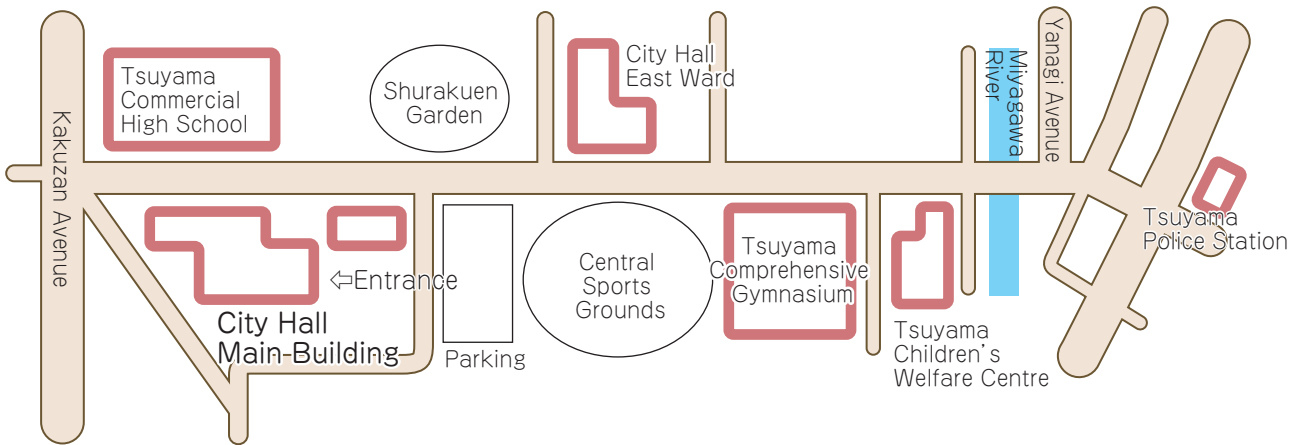

■The Plan of the City Hall (First Floor)

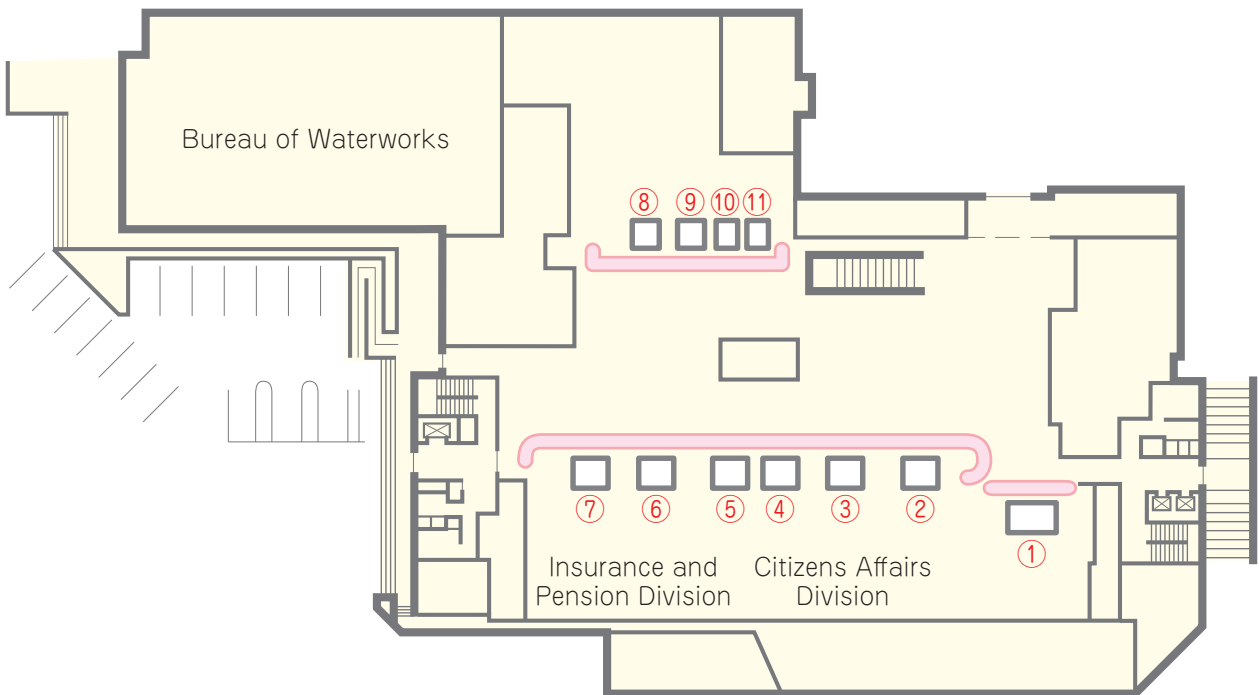

①	Environment and Living Division	⑦	National Health Insurance, Senior Persons Medical Insurance
②	Family Registry and Certificate of Residence	⑧	Welfare Services for the Disabled
③	Certificate issuing counter	⑨	Long-term Care Insurance
④	Alien Registration	⑩	Social Services
⑤	Passport issuing counter	⑪	Children's Issues Division branch office
⑥	National Pension Plan		

■ The Plan of the City Hall (Second Floor)

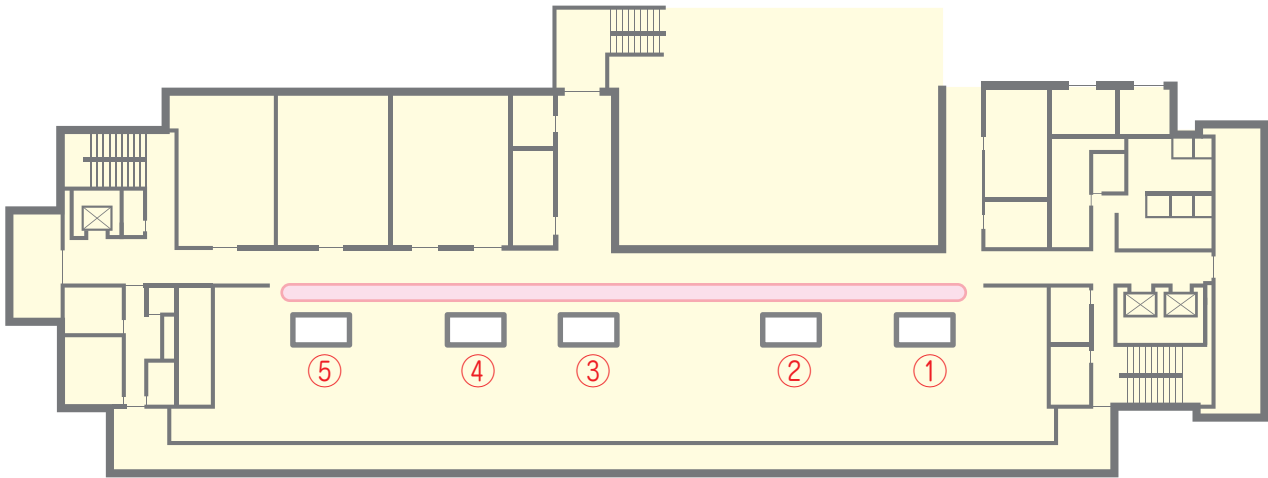

①	Tax payment consultation	④	Local inhabitants tax
②	Tax payment certificate	⑤	Fixed assets tax (Residential property and land)
③	Light motor vehicle tax, Enterprise tax, Fixed asset tax (Depreciable assets ⇒ see p.E-17)		

